

Insight Design Ltd Copyright. This drawing and design and all the information contained therein is the sole copyright of Insight Design Ltd and reproduction in any form is forbidden unless permission is obtained in writing.

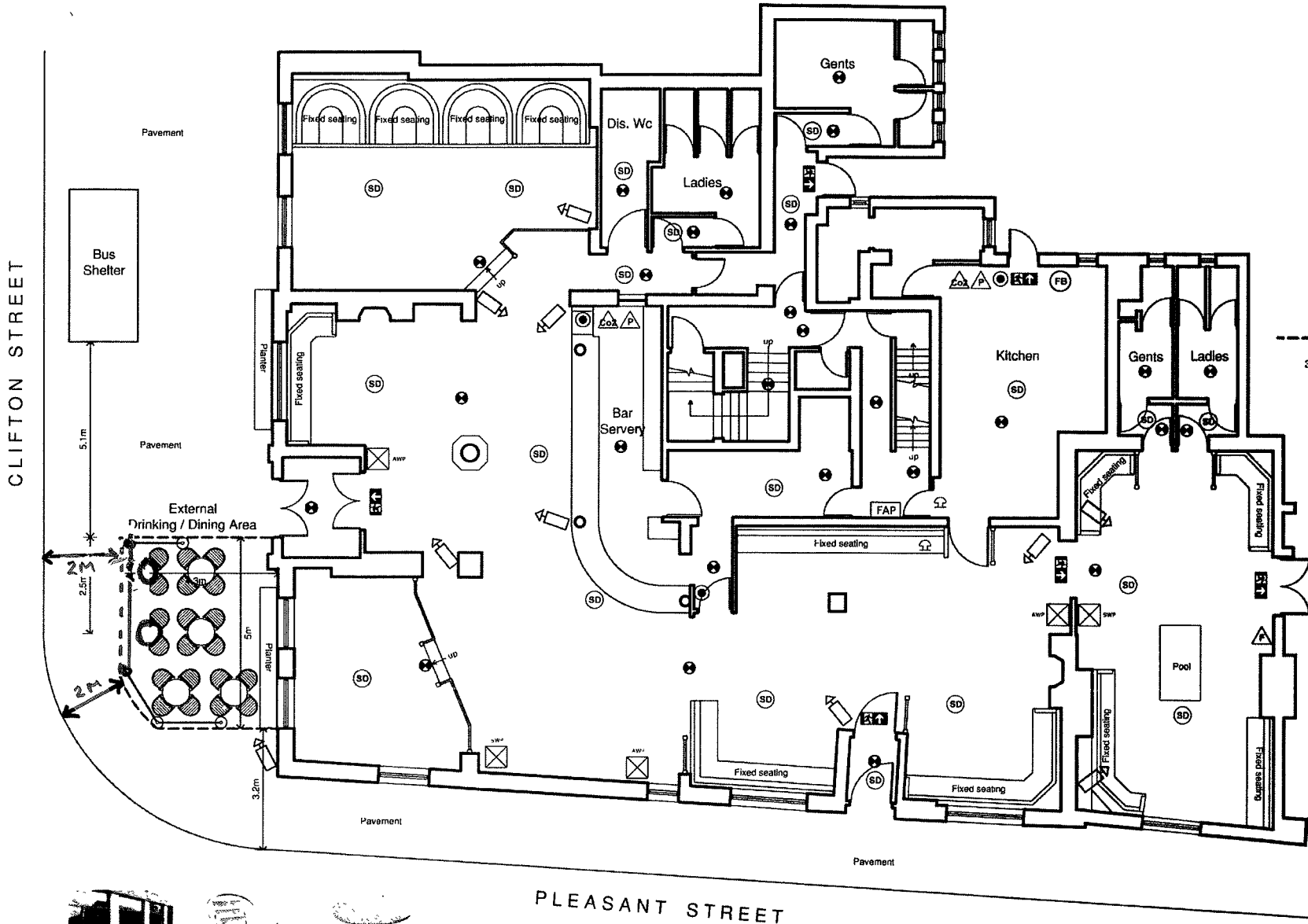

- Fire Blanket
- Water extinguisher
- Dry powder extinguisher
- Foam extinguisher
- Co2 extinguisher
- Smoke detector
- Illuminated exit sign to current legislation
- Break glass alarm point
- Alarm sounder
- Emergency Light
- Licensed Area
- 30FD:** Indicates 30min fire resistant door with smoke seals and self closing door closer.
- Fire alarm panel
- CCTV camera

B	Drawings as-built	08/10/18	ADH
A	Drawings & furniture added	03/10/14	ADH
<p>DO NOT SCALE. WRITTEN DIMENSIONS TO BE USED IN PREFERENCE TO SCALED DIMENSIONS. ALL DIMENSIONS TO BE CHECKED ON SITE BY CONTRACTORS & ALL DISCREPANCIES TO BE REPORTED TO THE DESIGNER.</p>			
<p>JOB TITLE SHIP & ROYAL 91 CLIFTON STREET LYTHAM, ST. ANNES LANC'S FY8 5EH</p>			
<p>OFFERING TITLE PROPOSED LICENSING PLAN</p>			
<p>CLIENT TITLE SPIRIT PUB COMPANY</p>			
SCALE 1:100 @ A3	DRAWING NO. 1936 / L01B		
DATE JULY 2014			
DRAWN BY ADH			
<p>UNIT 15 POMEROSEA BUSINESS PARK BRETHER LANE, HECROBURNWIRE WEST YORKSHIRE, WF16 6PR UK T. 01924 411720 F. 01924 411847 e. adh@insightdesign.co.uk</p>			
www.insightdesign.co.uk			

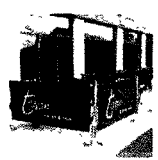

Banner style penmotor



Chair style



Table style