

Innsight Design Ltd Copyright. This drawing and design and all the information contained therein is the sole copyright of Innsight Design Ltd and reproduction in any form is forbidden unless permission is obtained in writing.

CLIFTON STREET

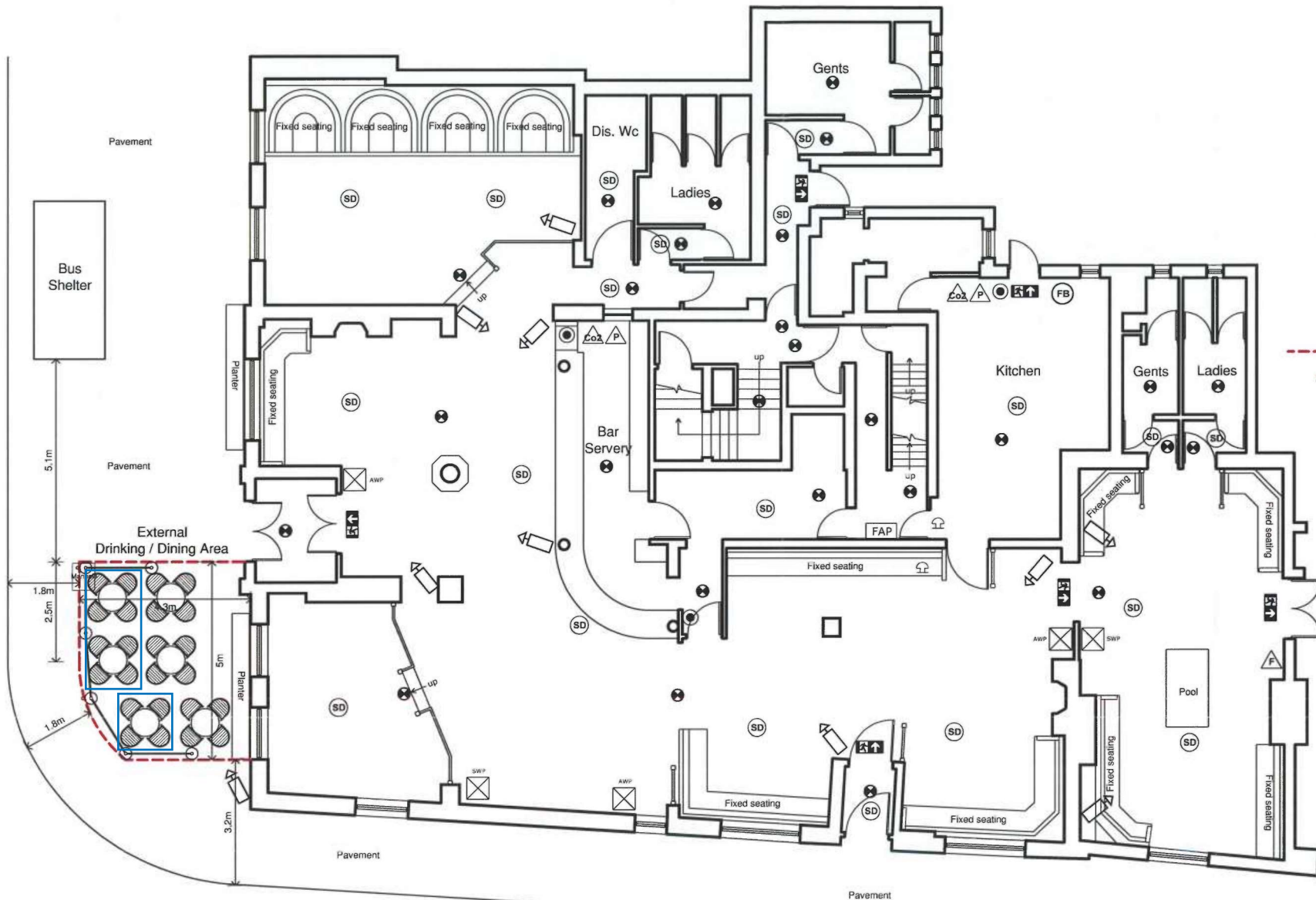

- (FB) Fire Blanket
- (W) Water extinguisher
- (P) Dry powder extinguisher
- (F) Foam extinguisher
- (Co2) Co2 extinguisher
- (SD) Smoke detector
- Illuminated exit sign to current legislation
- Break glass alarm point
- Alarm sounder
- Emergency Light
- Licensed Area
- 30FD s Indicates 30min fire resistant door with smoke seals and self closing door closer.
- (FAP) Fire alarm panel
- CCTV camera
- non-smoking tables

B	Dimensions revised.	06.10.14	ADH
A	Dimensions & furniture added	03.10.14	ADH
DO NOT SCALE. WRITTEN DIMENSIONS TO BE USED IN PREFERENCE TO SCALED DIMENSIONS. ALL DIMENSIONS TO BE CHECKED ON SITE BY CONTRACTOR & ALL DISCREPANCIES TO BE REPORTED TO THE DESIGNER.			
JOB TITLE SHIP & ROYAL 91 CLIFTON STREET LYTHAM, ST. ANNES LANCS FY8 5EH			
DRAWING TITLE PROPOSED LICENSING PLAN			
SPIRIT PUB COMPANY			
SCALE 1:100 @ A3	DRAWING No 1936 / L01B		
DATE JULY 2014	DRAWN BY ADH		
UNIT 61 PONDEROSA BUSINESS PARK SWITHES JANE HECKMOROVIRE WEST YORKSHIRE, WF16 9FR UK t. 01924 411737 f. 01924 411947 e. admin@innsightdesign.co.uk www.innsightdesign.co.uk			



Banner style perimeter



Chair style



Table style

PLEASANT STREET