

I:\sfp02\Maritime\PROJECTS\Coastal\St Annes Seawall OBC\Drawings\B550X002-016 - Option 3C-1 - General Arrangement.dwg - 27/04/2021 09:15:13 - A1Frame - MidwinterAJ

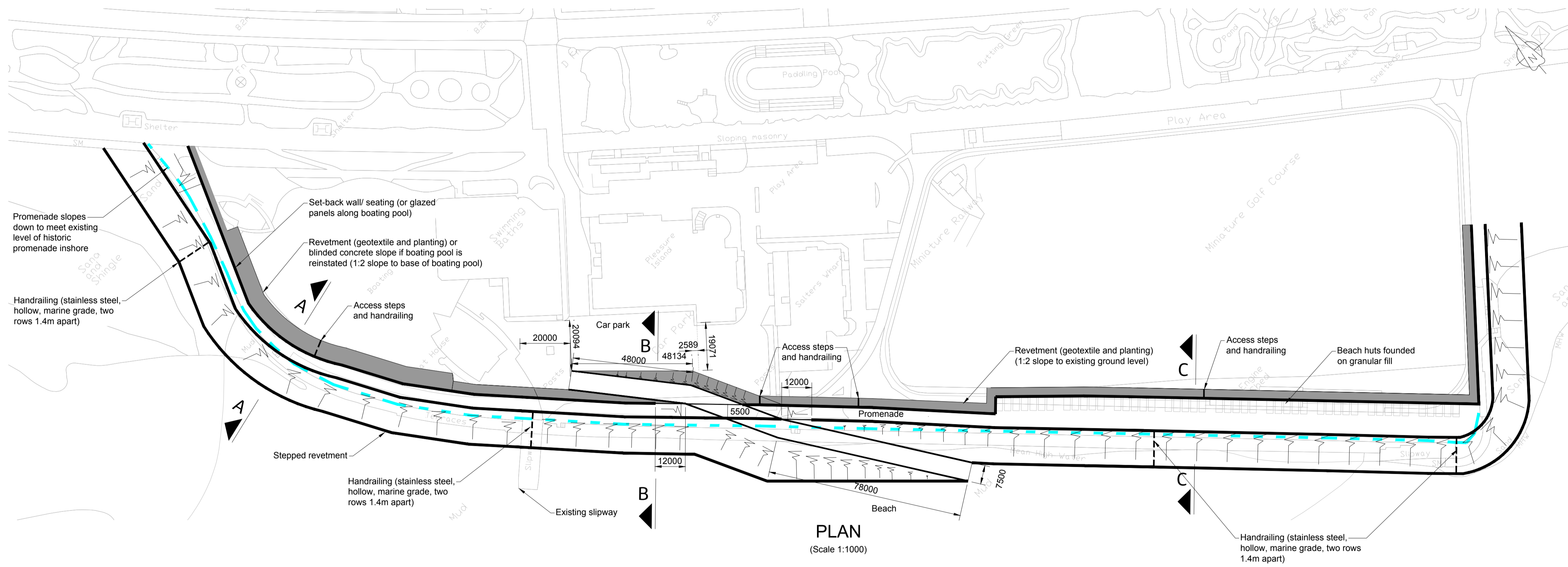

PLAN
 (Scale 1:1000)

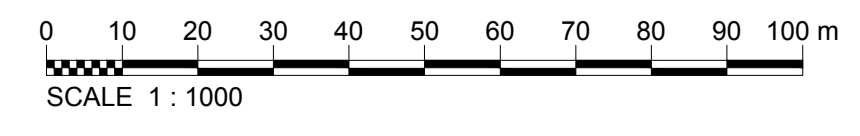

- Notes:
- All dimensions in millimetres unless otherwise stated
 - All levels to Ordnance Datum Newlyn

Key:

Pleasure Island -----

Complex Seawall -----

P02	2021-04-27	SECOND DRAFT	AM	IV	MP	MP
P01	2021-04-12	INITIAL DRAFT	AM	IV	MP	MP
Rev	Rev. Date	Purpose of revision	Orig	Check'd	Rev'd	Apprv'd

Jacobs
 95 Bothwell St, Glasgow, G2 7HX
 Tel: +44(0)141 243 8000 Fax: +44(0)141 226 3109
 www.jacobs.com

Client: **Fylde Council**

Project: **St Annes Seawall Outline Business Case**

Drawing title: **Outline Design Option 3C-1 General Arrangement**

Drawing status: **FOR REVIEW AND COMMENT** Suitability: **S03**

Scale: 1:1000@ A1 DO NOT SCALE

Jacobs No.: B550X002 Rev: **P02**

Drawing number: **B550X002-016**

© Copyright 2021 Jacobs U.K. Limited. The concepts and information contained in this document are the property of Jacobs. Use or copying of this document in whole or in part without the written permission of Jacobs constitutes an infringement of copyright. Limitation: This drawing has been prepared on behalf of, and for the exclusive use of, the Client, and is subject to, and issued in accordance with, the provisions of the contract between Jacobs and the Client. Jacobs accepts no liability or responsibility whatsoever for, or in respect of, any use of, or reliance upon, this drawing by any third party.